

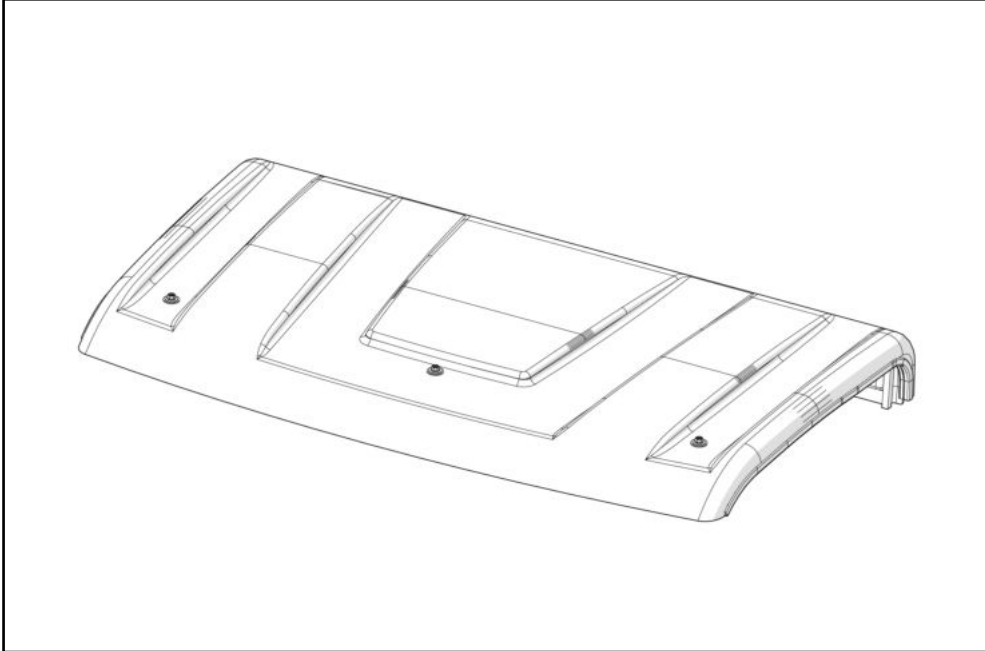

**Polaris Ranger 1000 Roof Kit**  
**Kit p/n:1POLXP1000RF**  
**Fits Tractor Models:**  
**POLARIS RANGER 900, XP 900, 1000**  
**& XP 1000**



**Available Options:**

- 1. Door Kit (P/N: 1POLXP1000DR)
- 2. Windshield Kit (P/N: 1POLXP1000WS)
- 3. Rear Panel Kit (P/N: 1POLXP1000RP)
- 4. Front Wiper Kit (P/N 1POLXP1000WK)
- 5. Side View Mirrors (P/N: 9PM5)
- 6. Door Restraint Kit (P/N: 1POLXP1000GS)

Approximate Installation Time *
Experienced Dealer Technician – 15 minutes
Average Dealer Technician – 20 minutes
Do-It-Yourself – 30 minutes

(\*=Not including accessories)

Approximate Product Specifications
Weight: 18 lbs.
Cab Width: 57.5 inches

**Register** your new product quickly online at [Curtiscab.com/product-registration/](http://Curtiscab.com/product-registration/)



Curtis encourages all customers to register their Curtis products. However, failure to do so will not diminish right to warranty. Curtis Industries does not sell or share your information with anyone else.

**Download** a digital copy of your installation instructions online at [Curtiscab.com/literature/](http://Curtiscab.com/literature/)



Curtis strives to continuously improve our products, technical documentation, etc. Therefore, the installation manual for this product may have been updated after your product was packaged. The latest revision of the installation manual can always be found at the website above.

The contents of this envelope are the property of the owner. Leave with the owner when installation is complete.

# TABLE OF CONTENTS

WARNINGS, TIPS, & REQUIRED TOOLS..... 2  
 KIT INSTALLATION ..... 3-4  
 CARE AND MAINTENANCE..... 4  
 SERVICE PARTS ..... 4  
 BOLT TORQUE SPECIFICATIONS ..... 5-6

## WARNINGS, TIPS, & REQUIRED TOOLS

Curtis cabs, kits, and accessories feature an assembly of parts designed for your vehicle which require adjustment and alignment of components to accommodate vehicle variations and provide proper weather protection. For accurate installation, proper operation, and years of satisfaction, please read and understand the installation and owner's manual fully prior to installing the roof kit.

From all of us at Curtis, we thank you for choosing our product.



**ADDED WEIGHT NOTICE**

Curtis Cabs, blades and general accessories add additional weight to the base vehicle. All Curtis accessory weights are listed in product brochures. Deduct the accessory's total weight from the vehicle's rated capacity and never exceed the vehicle's rated capacity including driver and passenger.

**WARNING** Exposure to Carbon Monoxide can Cause illness, serious injury or death. Never operate vehicle if suspicious of Carbon Monoxide. Inspect exhaust system for leaks monthly. Leaks can result from loose connections, corrosion, cracks or other damage to the exhaust manifold. If leaks are found, repair or replace exhaust system. Do not use vehicle until repair or replacement is complete.

**WARNING**

**Serious Injury or Death**

	This cab enclosure does not provide protection from rollover or other accidents.
	This cab enclosure does not provide protection from flying objects including golf balls.
	This cab enclosure does not provide protection from lightning. When lightning threatens take cover and do not operate vehicle.

**California Health and Safety Proposition 65 Warning:** This product may contain chemicals known to the state of California to cause cancer and birth defects or other reproductive harm.

## GENERAL INFORMATION BEFORE YOU START

### HELPFUL HINTS:

- Refer to parts diagram found in the service parts section of this manual to help identify parts during the assembly process.
- To assist with the roof installation, leave all fasteners loose for later adjustment unless otherwise specified.
- Read and understand all instructions before beginning.
- Apply a silicone sealant to seal any minor gaps that may occur due to vehicle variations.
- Before installing parts with factory installed rubber, make sure the rubber is fully installed onto the parts for proper fit and sealing.
- Plastic washers have been supplied to provide a weather seal under the heads of some exterior bolts. The plastic washer should be installed under each bolt head directly against the outside cab surface. Care should be taken not to over tighten the fasteners and damage the plastic washer.
- Make sure the areas where the supplied self-adhesive hook Velcro will be applied are clean and dry and at room temperature for best adhesion.

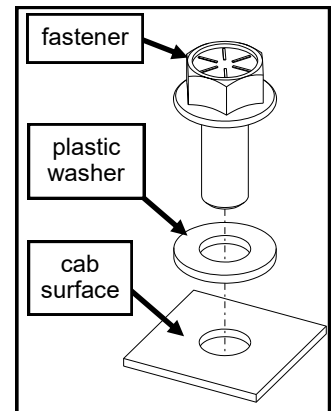

### TOOLS REQUIRED:

- Set of Standard and Metric Sockets (3/8" Drive)
- 3/8" Drive Ratchet and Long Drive Extension
- Set of Standard and Metric Open-End Wrenches
- Scissors
- Drill/Driver

# KIT INSTALLATION

## STEP 1: (VEHICLE PREP)

If installing multiple Curtis Polaris Ranger 1000 kits, install in the following order.

1. Doors
2. Windshield
3. Rear Panel
4. Roof

- 1.1 Per figure 1.1, apply 1/2" X 9/16" foam rubber weatherseal from the left ROPS across the windshield mount and to the right ROPS. Cutting the ends half way down the radius of the ROPS as shown. Keep extra foam rubber for next step.

### Tools required

Scissors

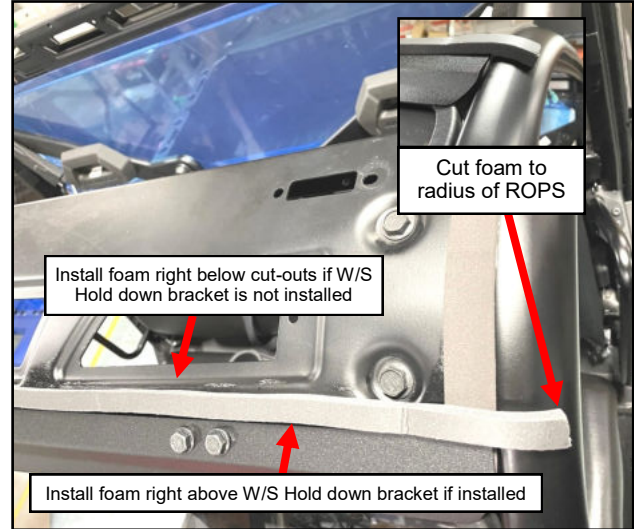

Fig. 1.1 (Apply foam rubber to windshield mount)

## STEP 2: (KIT INSTALLATION)

- 2.1 Cut (2) pieces of 1/2" X 9/16" foam rubber weatherseal 5-1/8" long. Per figure 2.1, install foam rubber in the left and right corners of the underside of the roof.

### Tools required

Scissors

- 2.2 Position roof on top of ROPS. Per figure 2.2, install rear flange mounting hardware. Install rubber seal washer against roof then steel washer and screw. Note that the M6 screws are thread forming. Keep screws straight to avoid cross threading when installing. **Note: recommend placing roof on top of vehicle by dropping down in place to prevent damage to installed foam rubber on vehicle and roof.**

### Hardware Used

	<u>Qty</u>
M6x1 X 20 Hex Head Flange Screw	4
1/4" X 1" Steel Fender Washer	4
1/4" X 1" Seal Washer	4

### Tools required

10mm socket and wrench

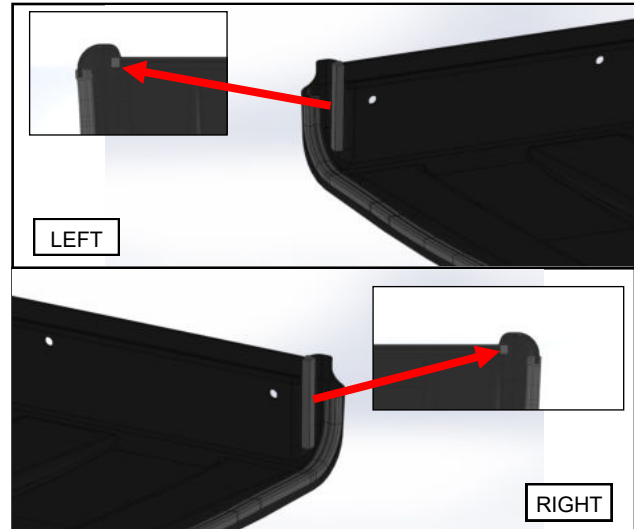

Fig. 2.1 (Install Foam Rubber in Back Corners)



Fig. 2.2 (Install back screws and washers)

## KIT INSTALLATION

### STEP 2: (KIT INSTALLATION CONT'D)

**2.3** Per figure 2.3, install front mounting hardware listed below. Install rubber seal washer against roof then steel washer and screw. Note that the center bolt location may require assistance to tighten down.

<u>Hardware Used</u>	<u>Qty</u>
5/16-18 X 1" Hex Head Flange Screw	3
5/16" X 1" Steel Fender Washer	3
5/16" X 1-1/4" Seal Washer	4

Tools required  
1/2" socket and wrench

**2.4** Roof kit installation is complete.

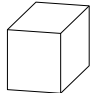



Fig. 2.3 (Install front screws, washers & lock nuts)

## CARE AND MAINTENANCE

- Check and tighten hardware after 40 hours of operation. Periodically inspect and tighten hardware for the remainder of the unit's life.

## POLARIS RANGER 1000 ROOF KIT SERVICE PARTS

RUBBER FOAM, 1/2" X 9/16"	1/2" SIDE BULB WITH 1/4" GRIP
	
9SV-PR43-4	9SV-PR29-15

# Torque Specs. for Structural Bolts

This page is for use primarily when dealing with high-strength vehicle fasteners such as ROPS hardware that hold the structure together for safety. This page can also be used for other solid metal-to-metal joints. **Do not** use these high torque values on any of the following applications involving: tubing, plastic, nylon or rubber washers, threaded inserts, etc.. See next page regarding less critical fasteners.

The values below apply to fasteners that are dry or lubricated with normal engine oil. They do not apply if special graphited or moly disulphide greases or other extreme pressure lubricants are used. This applies to both UNF and UNC threads. Remember to always use the same grade or property class when replacing bolts.

**IMPORTANT: on all PLATED GRADE 8 bolts, reduce torque 15% from listed bolt torque specification.**

SAE Grade No.		2				5				8*				
Bolt head identification mark as per grade. NOTE: Manufacturing Marks Will Vary														
		TORQUE		TORQUE		TORQUE		TORQUE		TORQUE		TORQUE		
Bolt Size	Inches	Millimeters	Pounds Feet		Newton-Meters		Pounds Feet		Newton-Meters		Pounds Feet		Newton-Meters	
			Min.	Max.	Min.	Max.	Min.	Max.	Min.	Max.	Min.	Max.	Min.	Max.
1/4	6.35	5	6	7	8	9	11	12	15	12	15	16	20	
5/16	7.94	10	12	14	16	17	20.5	23	28	24	29	33	39	
3/8	9.53	20	23	27	31	35	42	48	57	45	54	61	73	
7/16	11.11	30	35	41	47	54	64	73	87	70	84	95	114	
1/2	12.70	45	52	61	70	80	96	109	130	110	132	149	179	
9/16	14.29	65	75	88	102	110	132	149	179	160	192	217	260	
5/8	15.88	95	105	129	142	150	180	203	244	220	264	298	358	
3/4	19.05	150	185	203	251	270	324	366	439	380	456	515	618	
7/8	22.23	160	200	217	271	400	480	542	651	600	720	814	976	
1	25.40	250	300	339	406	580	696	787	944	900	1080	1220	1464	
1-1/8	25.58	-	-	-	-	800	880	1085	1193	1280	1440	1736	1953	
1-1/4	31.75	-	-	-	-	1120	1240	1519	1681	1820	2000	2468	2712	
1-3/8	34.93	-	-	-	-	1460	1680	1980	2278	2380	2720	3227	3688	
1-1/2	38.10	-	-	-	-	1940	2200	2631	2983	3160	3560	4285	4827	

\*Thick Nuts must be used with Grade 8 bolts

## METRIC BOLT TORQUE SPECIFICATIONS



Size of Screw	Property Class	Course Thread			Fine Thread		
		Pitch (mm)	Pounds Feet	Newton-Meters	Pitch (mm)	Pounds Feet	Newton-Meters
M6	5.6	1.0	3.6-5.8	4.9-7.9	-	-	-
	8.8		5.8-9.4	7.9-12.7		-	-
	10.9		7.2-10	9.8-13.6		-	-
M8	5.6	1.25	7.2-14	9.8-19	1.0	12-17	16.3-23
	8.8		17-22	23-29.8		19-27	25.7-36.6
	10.9		20-26	27.1-35.2		22-31	29.8-42
M10	5.6	1.5	20-25	27.1-33.9	1.25	20-29	27.1-39.3
	8.8		34-40	46.1-54.2		35-47	47.4-63.7
	10.9		38-46	51.5-62.3		40-52	54.2-70.5
M12	5.6	1.75	28-34	37.9-46.1	1.25	31-41	42-55.6
	8.8		51-59	69.1-79.9		55-68	75.9-92.1
	10.9		57-66	77.2-89.4		62-75	84-101.6
M14	5.6	2.0	49-56	66.4-75.9	1.5	52-64	70.5-86.7
	8.8		81-93	109.8-126		90-106	122-143.6
	10.9		96-109	130.1-147.7		107-124	145-168
M16	5.6	2.0	67-77	90.8-104.3	1.5	69-83	93.6-112.5
	8.8		116-130	157.2-176.2		120-138	162.6-187
	10.9		129-145	174.8-196.5		140-158	189.7-214.1
M18	5.6	2.0	88-100	119.2-136	1.5	100-117	136-158.5
	8.8		150-168	203.3-227.6		177-199	239.8-269.6
	10.9		175-194	237.1-262.9		202-231	273.7-313
M20	5.6	2.5	108-130	146.3-176.2	1.5	132-150	178.9-203.3
	8.8		186-205	252-277.8		206-242	279.1-327.9
	10.9		213-249	288.6-337.4		246-289	333.3-391.6

## Tightening of Non-Structural Bolts

For light or medium duty fastening, Curtis recommends using a general industry standard of tightening until snug and then giving an additional one quarter turn of the tool as deemed reasonable for the application (i.e.: at the installer's discretion).

If torque values are required, the examples listed below are intended as a reasonable reference for use in the majority of non-structural fastener applications such as: small diameter fasteners; bolts passing thru tubing, glass, plastic, nylon or rubber washers, threaded inserts, etc.

If more than one application below applies, use the lower torque value.

FASTENER SIZE:	FASTENER TYPE:	WASHER MATERIAL:	APPLICATION:	TORQUE (INCH-POUNDS) (±5)
#10	Machine Screws	-	in Nylon P-Clamps	20
#10	Machine Screws	-	Strobe Light (plastic base)	35
M5	Set Screws	-	Wiper Arm	20
1/4"	Cap Nut	-	Windshield Wiper	20
1/4"	Bolts	-	Tubing (5/8" to 3/4" wide)	132
1/4" - M6	Bolts	Rubber	-	60
1/4"	Bolts	Nylon / Plastic	-	72
1/4"	Bolts	-	Factory Installed Threaded Inserts	132
5/16"	Bolts	-	Tubing (1" or wider)	60
5/16"	Flat Head Bolts	-	Plastic Windshield Hinge	79
5/16"	Bolts	Rubber	-	120
5/16"	Bolts	Nylon / Plastic	-	150
5/16"	Ball Studs	-	-	150
5/16"	Bolts	-	Factory Installed Threaded Inserts	240
3/8"	Bolts	-	Tubing	120
M12	Door Striker Pins	-	-	120