



Kubota BX80
Advantage Cab with Heater (p/n: 1KBX80CA2)
Plus Cab with Heater (1KBX80PC)
Base Cab (1KBX80EN)

While this cab kit was designed to fit on the vehicle(s) listed above, manufacturing tolerances and vehicle assembly may affect cab fitment. It is the responsibility of the cab installer to check all vehicle pedals and levers for full functionality and, as required, adjust the cab fitment to prevent any interference of the cab components with the travel of pedals or levers.



Available Options:

1. Front LED Work Lights (P/N: 9LEDW4)
2. Rear LED Work Lights (P/N: 9LEDW3)
3. Strobe Light (P/N: 9LEDS2)
4. Dome Light (P/N: 9LEDD14)

Approximate Installation Time *
Experienced Dealer Technician – 5 Hours
Average Dealer Technician – 6 Hours
Do-It-Yourself – 7 Hours

(*=Not including accessories)

Approximate Product Specifications
Floorboard to Roof Height: 59-1/4 inches
Weight: 305 lbs., 280 lbs., or 250 lbs.
Cab Width: 47-1/2 inches

The contents of this envelope are the property of the owner. Leave with the owner when installation is complete.

KUBOTA BX80 CAB SERVICE PARTS

ROOF ASSEMBLY
P/N: 8SV-101-00046

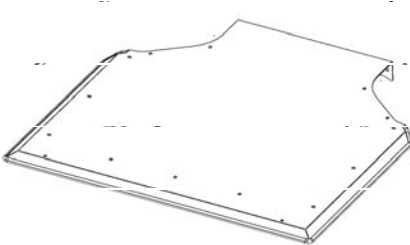

WINDSHIELD ASSEMBLY, 40" X 31.19"
P/N: 8SV-102-00023

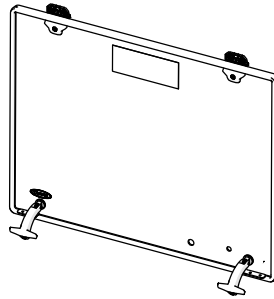

WINDSHIELD SUPPORT ASSEMBLY
P/N: 8SV-103-00018

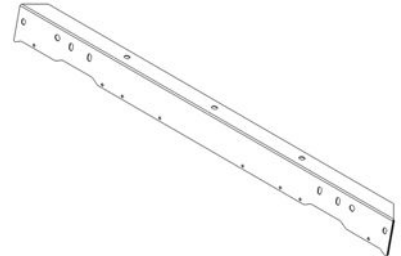

A-PILLAR ASSEMBLY, LEFT & RIGHT
P/N: 8SV-104-00022-L
P/N: 8SV-104-00022-R

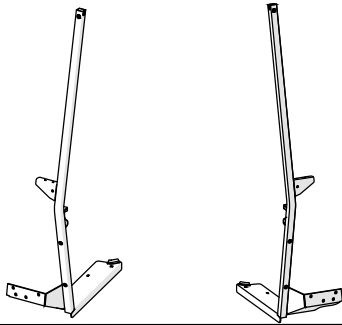

COWL ASSEMBLY
P/N: 8SV-105-00018

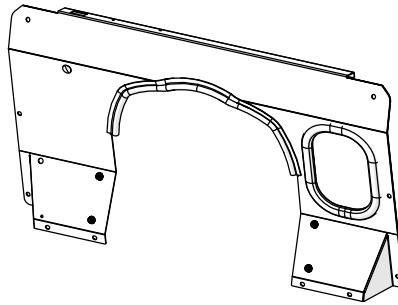

GLASS REAR PANEL LIFT OFF,
27.00 X 20.88, 3/16" THICK
P/N: 8SV-106-00024

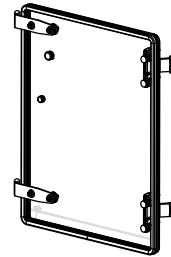

DOOR ASSEMBLY, LEFT
P/N: 8SV-107-00027-L

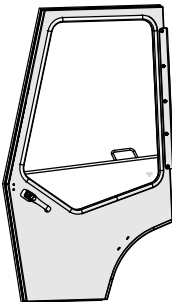

DOOR ASSEMBLY, RIGHT
P/N: 8SV-107-00027-R

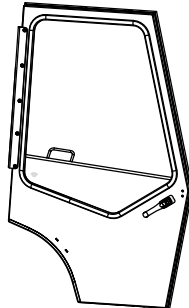

REAR LEG ASSEMBLY, LEFT
P/N: 8SV-108-00014-L

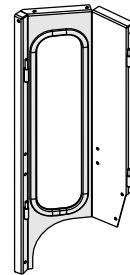

REAR LEG ASSEMBLY, RIGHT
P/N: 8SV-108-00014-R

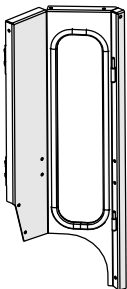

CONTOUR ASSEMBLY, LEFT & RIGHT
P/N: 8SV-113-00121-L
P/N: 8SV-113-00121-R

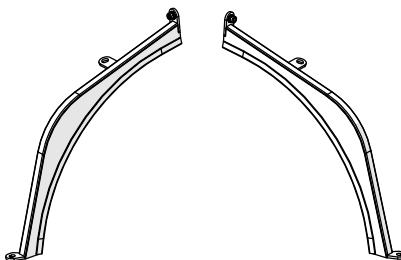

DOOR HEADER ASSEMBLY, LEFT & RIGHT
P/N: 8SV-113-00167-L
P/N: 8SV-113-00167-R

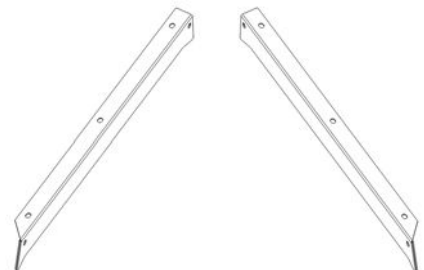

KUBOTA BX80 CAB SERVICE PARTS

VINYL HINGED DOOR, LEFT
P/N: 8SV-107-00044-L

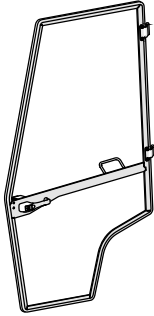

VINYL HINGED DOOR, RIGHT
P/N: 8SV-107-00044-L

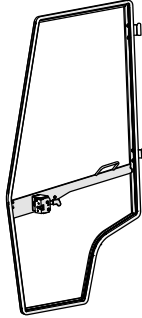

UPPER REAR CURTAIN
P/N: 8SV-112-00059

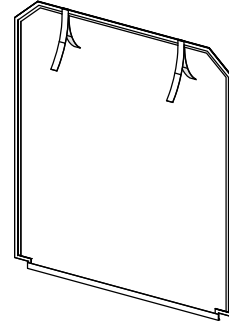

VINYL DOOR SKIN, LEFT
P/N: 8SV-112-00057-L

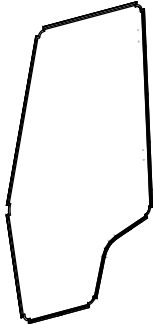

VINYL DOOR SKIN, RIGHT
P/N: 8SV-112-00057-R



STRIKER MOUNTING PLATE
P/N: 8SV-SM-01900-O

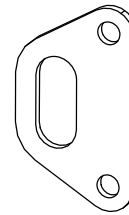

VINYL CURTAIN DOOR, LEFT
P/N: 8SV-112-00058-L

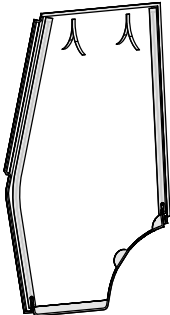

VINYL CURTAIN DOOR, RIGHT
P/N: 8SV-112-00058-R

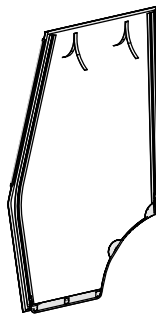

STRIKER BRACKET
P/N: 8SV-SM-01937

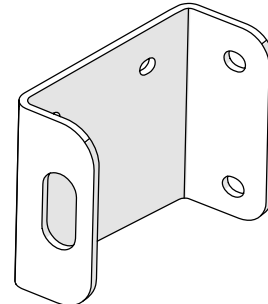

VINYL DOOR HINGE KIT, TOP & BOTTOM,
LEFT P/N: 8SV-HKWCA-O-L

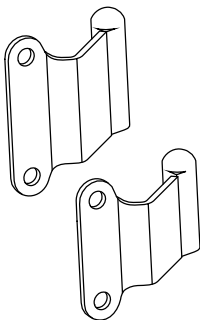

VINYL DOOR HINGE KIT, TOP & BOTTOM,
RIGHT P/N: 8SV-HKWCA-O-R

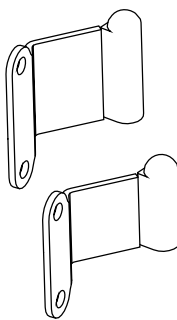

KUBOTA BX80 CAB SERVICE PARTS

REAR LIGHT MOUNT, LEFT
P/N: 8SV-110-00048-L

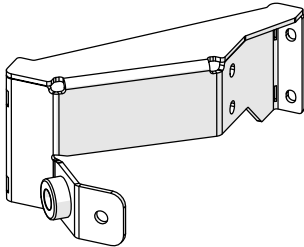

REAR LIGHT MOUNT, RIGHT
P/N: 8SV-110-00048-R

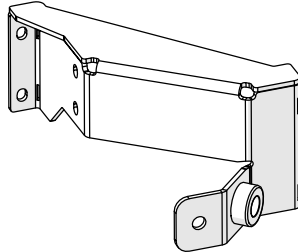

ROPS BRACKET, LEFT & RIGHT
P/N: 8SV-SM-01006-L
P/N: 8SV-SM-01006-R

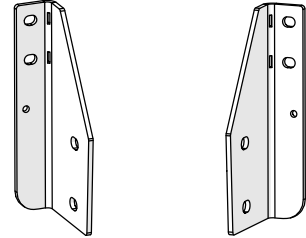

RADIATOR SHROUD
P/N: 8SV-111-00021

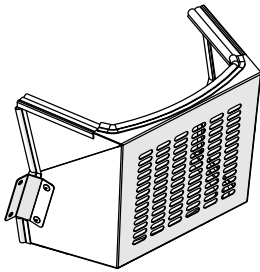

DOOR WINDOW WITH RUBBER
P/N: 8SV-9GL-00044

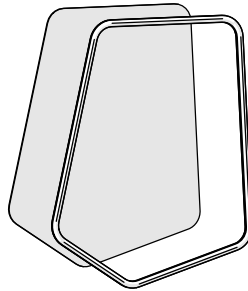

REAR FILLER
P/N: 8SV-112-00034

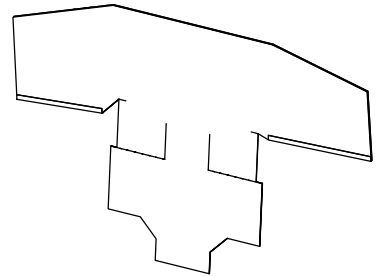

RADIATOR SHROUD COVER
P/N: 8SV-112-00033

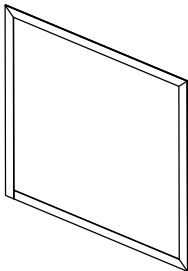

GLASS HINGE SLEEVE WITH
MOUNTING HARDWARE
P/N: 8SV-PL-00021

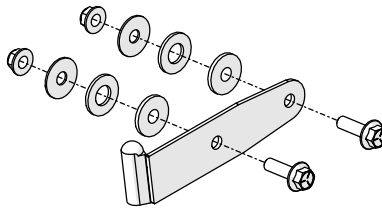

HEATER BRACKET
P/N: 8SV-SM-01010

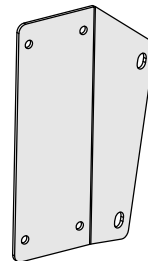

DOOR HINGE, LEFT & RIGHT
P/N: 8SV-WA00185L-O
P/N: 8SV-WA00185R-O

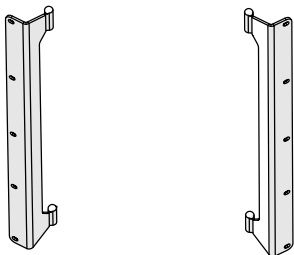

FLOORBOARD BRACKET
P/N: 8SV-SM-01011

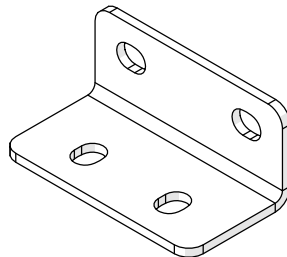



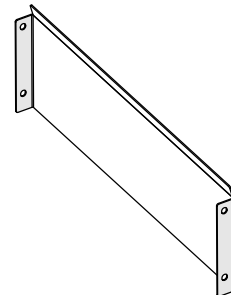



LOWER REAR PANEL
P/N: 8SV-SM-01072

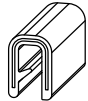

ADDITIONAL SERVICE PARTS

PART NUMBER	DESCRIPTION
8SV-P-00078	COWL WINDOW WITH RUBBER
8SV-P-00079	REAR LEG WINDOW WITH RUBBER
9SV-DP11	DOME PLUG 1/2" (BAG OF 10)
9SV-DP10	DOME PLUG 3/8" (BAG OF 10)
9SV-HWS	WINDSHIELD HINGE KIT
9BLK01	WINDSHIELD HINGE BLOCK SPACER, TALL STYLE, 3/4" THICK
9PWM110	WIPER MOTOR, 110 DEGREE
9PWB20-FB	WIPER BLADE, 20", FLEX
9PWA14-16	WIPER ARM, ADJUSTABLE LENGTH (11" - 16")
9PWK-HB	GLASS MOUNTING KIT FOR WIPER SYSTEMS
9SV-DSTRH	DOOR STRIKER KIT-INCLUDES CASE HARDENED STRIKER BOLT
9SV-IHRL	INSIDE HANDLE ROTARY LATCH KIT (INCL. L & R)
9SV-OHRL	OUTSIDE HANDLE ROTARY LATCH KIT (SET OF 2)
9SV-9PHW010-W	HINGE WASHER, KIT (SET OF 4) OD .635, ID .41, THK .08
9PI01	POLY INSERT 1", 14-20 GA BLK MATTE, INSERT FINES .94/.95 (QTY.: 1)
9PI02	POLY INSERT 3/4", 14-20 GA BLK MATTE FINISH, INSERT FINES 0.69 (QTY.: 1)
9SV-WL1	WINDSHIELD LATCH KIT 1, POPS OPEN W/S FOR VENTING ONLY
8SV-WL3	WINDSHIELD LATCH & BRKT ASSY. SGL POST (SET OF L&R)
9SV-VM01	5/8" THICK RUBBER BUMPER (2)
9SV-9DPSB	HEATER HOSE BUSHINGS, SNAP BUSHING, .750" X 1.093" (QTY.: 1)
8SV-9HR-00001-5	NYLON SLEEVING, 2.38" I.D., 5' LENGTH
9SV-9HR-00008	THERMOSTAT SPACER, BX80 HEATER
9SV-9HR0039	90 DEGREE HEATER HOSE ELBOW 5/8" BARBED ENDS
9SV-9HR0042	1" TEE FITTING
9SV-9HR0045	BLOCK ADAPTER (3/8" NIPPLE)
9SV-9HR00601.0	HOSE CLAMPS #10 (1") (QTY.: 6)
9SV-9HR00601.5	HOSE CLAMPS #16 (1.5") (QTY.: 2)
9SV-UHTRILV	UNIVERSAL HEATER IN-LINE VALVE (SET OF 2)
9SV-9HR0048	ROCKER SWITCH (HI-OFF-LOW)
9SV-9HR-L	REPLACEMENT LOUVER-15,000 & 20,000 BTU HEATER, KL47
8SV-9PH20WG	TUCK-AWAY HEATER WITH WIRED GROUND
9SV-HRH61-20	HEATER HOSE (5/8" I.D.)-20 FT
9PH20-2	FAN 120 x 120 x 38 12VDC 12W 3200 RPM
9SV-WH-00072	WIRING HARNESS POWER
9SV-WH-00090	WIRING HARNESS, REAR LIGHT
8SV-WH-GF	WIRE HARNESS, GLASS FUSE
9DL01H	KEYS, SET OF 2 ON A RING, FOR HANDLE 1096-1, KEY CODE C40

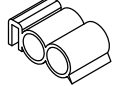
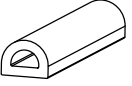
TRIM LOK, STD, 1/16" - 1/8" GRIP	5/8" STD BULB, 1/16" GRIP	ARCH PSA RUBBER	WINDOW RUBBER	1" STD BULB, 1/16" GRIP	3/4" SIDE BULB, 1/4" GRIP	5/8" SIDE BULB, 1/4" GRIP	1-1/2" DOUBLE SIDE BULB	ARCH PSA .2 X .15
								
9SV-PRO1-10	9SV-PRO2-15	9SV-PRO9-10	9SV-PR10-10	9SV-PR19-10	9SV-PR38-15	9SV-PR23-15	9SV-PR41-5	9SV-PR53-15

OPTIONAL ACCESSORIES FOR KUBOTA BX80 CAB

FRONT LED WORK LIGHTS (P/N: 9LEDW4)

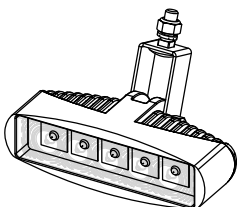

REAR LED WORK LIGHTS (P/N: 9LEDW3)

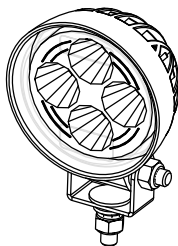

STROBE LIGHT (P/N: 9LEDS2)

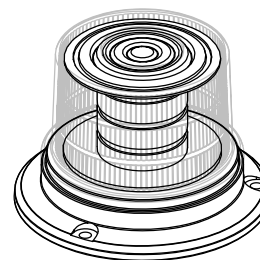

DOME LIGHT (P/N: 9LEDD14)

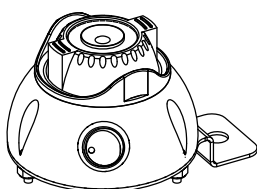

SIDE VIEW MIRRORS (P/N: 9PM5)

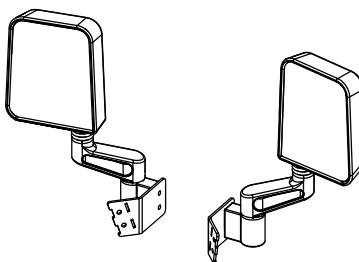

REAR VIEW MIRROR (P/N: 9PM3)

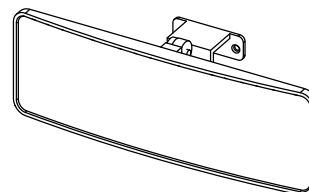

REAR WIPER KIT, 85 DEG W/ 12" FLEX BLADE (P/N: 9PWK8512F9-11A)

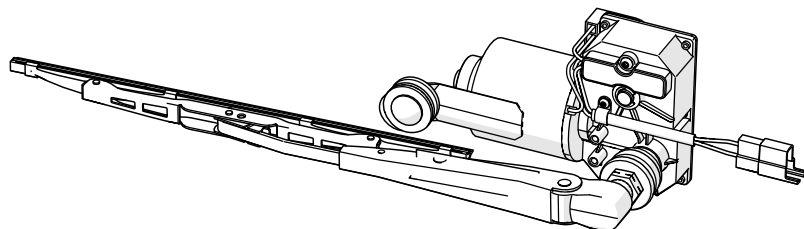

SEAL KIT (P/N: 9SK3)

