



**John Deere 3E
Cab with Heater p/n: 1JD3ECA2
fits tractor models: 3025E, 3032E & 3038E
(note: only fits with rear fuel tank/cap configuration)**

While this cab kit was designed to fit on the vehicle(s) listed above, manufacturing tolerances and vehicle assembly may affect cab fitment. It is the responsibility of the cab installer to check all vehicle pedals and levers for full functionality and, as required, adjust the cab fitment to prevent any interference of the cab components with the travel of pedals or levers.



Shown with front windshield wiper (comes standard with cab)

- Available Options:
1. Front LED Work Lights (P/N: 9LEDW4)
 2. Rear LED Work Lights (P/N: 9LEDW3)
 3. Strobe Light (P/N: 9LEDS2)
 4. Dome Light (P/N 9LEDD14)
 5. Side View Mirrors (P/N: 9PM5)
 6. Rear View Mirror (P/N: 9PM3)
 7. Rear Wiper (P/N: 9PWK8512F9-11A)
 8. Seal Kit (P/N: 9SK2)

Approximate Installation Time *
Experienced Dealer Technician – 5 Hours
Average Dealer Technician – 6 Hours
Do-It-Yourself – 7 Hours

(*=Not including accessories)

Approximate Product Specifications
Floorboard to Roof Height: 60 inches
Weight: 313 lbs.
Cab Width: 53.25 inches

The contents of this envelope are the property of the owner. Leave with the owner when installation is complete.

JOHN DEERE 3E CAB SERVICE PARTS

ROOF ASSEMBLY
P/N: 8SV-101-00044

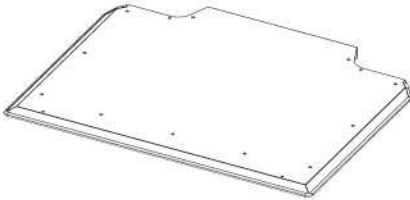

WINDSHIELD ASSEMBLY, 45.75" X 27"
P/N: 8SV-102-00022

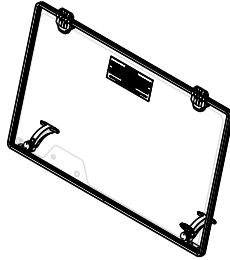

A PILLAR ASSEMBLY, LEFT
P/N: 8SV-104-00010-L



A PILLAR ASSEMBLY, RIGHT
P/N: 8SV-104-00010-R



COWL ASSEMBLY
P/N: 8SV-105-00014

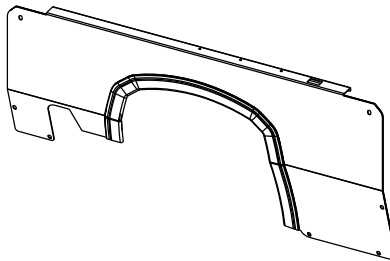

GLASS REAR PANEL LIFT OFF,
26.75X23.25, 3/16" THICK
P/N: 8SV-106-00023

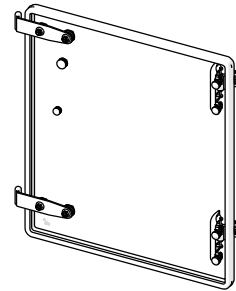

DOOR ASSEMBLY, LEFT
P/N: 8SV-107-00021-L

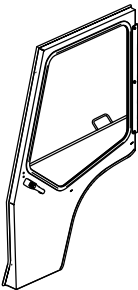

DOOR ASSEMBLY, RIGHT
P/N: 8SV-107-00021-R

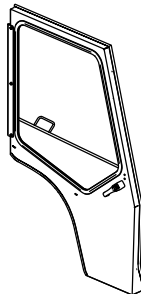

REAR LEG ASSEMBLY, LEFT
P/N: 8SV-108-00012-L

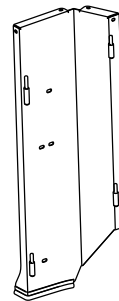

REAR LEG ASSEMBLY, RIGHT
P/N: 8SV-108-00012-R

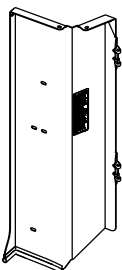

ROPS BRACKET, LOWER, LEFT
P/N: 8SV-110-00045-L

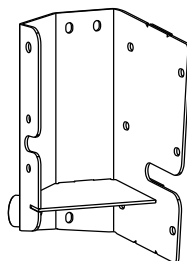

ROPS BRACKET, LOWER, RIGHT
P/N: 8SV-110-00045-R

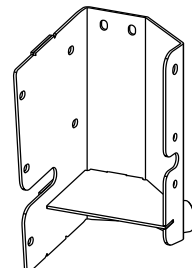

JOHN DEERE 3E CAB SERVICE PARTS

ROPS MOUNTING BRACKET
ASSY, LOWER
P/N: 8SV-110-00046

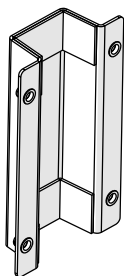

DOOR WINDOW WITH RUBBER
P/N: 8SV-9GL-00038

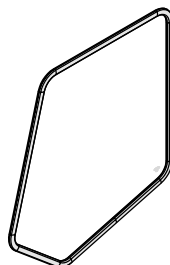

REAR FILLER
P/N: 8SV-112-00030

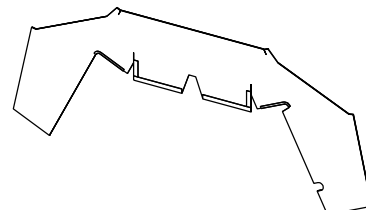

GLASS HINGE SLEEVE WITH
MOUNTING HARDWARE
P/N: 8SV-PL-00021

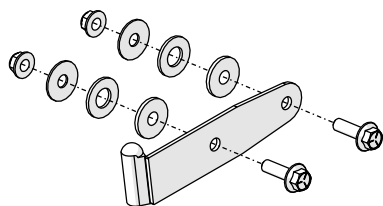

HEATER BRACKET
P/N: 8SV-SM-01017

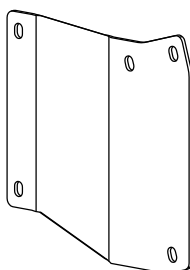

FRONT FILLER
P/N: 8SV-112-00031

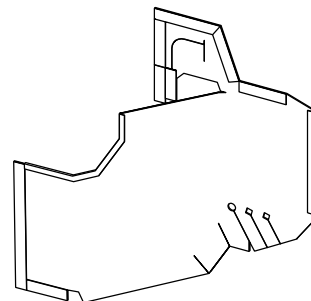

DOOR HINGE, LEFT
P/N: 8SV-WA00185L-JG

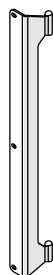

DOOR HINGE, RIGHT
P/N: 8SV-WA00185R-JG



UNDER SEAT FILLER
P/N: 8SV-112-00032

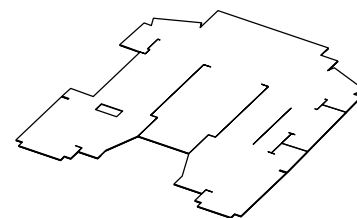

ROPS BRACKET, FOLDING PIN (2)
P/N: 8SV-SM-00982

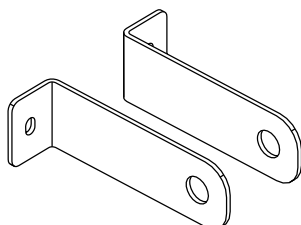

ROPS LOWER BRACKETS, (SET OF
LEFT / RIGHT) P/N: 8SV-SM-01021

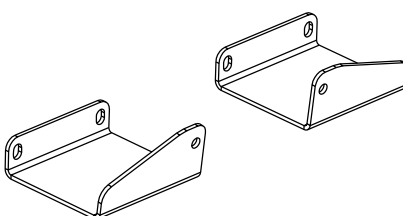

JOHN DEERE 3E CAB SERVICE PARTS

WINDSHIELD SUPPORT
P/N: 8SV-103-00017



DOOR HEADER, LEFT
P/N: 8SV-113-00157-L







DOOR HEADER, RIGHT
P/N: 8SV-113-00157-R



ADDITIONAL SERVICE PARTS

PART NUMBER	DESCRIPTION
9SV-DP11	DOME PLUG 1/2" (BAG OF 10)
9SV-DP10	DOME PLUG 3/8" (BAG OF 10)
8SV-WL3	WINDSHIELD LATCH & BRKT ASS'Y. SGL POST (SET OF L&R)
9SV-HWS	WINDSHIELD HINGE KIT
9PWM110	WIPER MOTOR, 110 DEGREE
9PWB20-FB	WIPER BLADE, 20", FLEX
9PWA14-16	WIPER ARM, ADJUSTABLE LENGTH (11" - 16")
9PWK-HB	GLASS MOUNTING KIT FOR WIPER SYSTEMS
9SV-DSTR-2	DOOR STRIKER KIT (SET OF 2)
9SV-IHRL	INSIDE HANDLE ROTARY LATCH KIT (INCL. L & R)
9SV-OHRL	OUTSIDE HANDLE ROTARY LATCH KIT (SET OF 2)
9SV-9PHW010-W	HINGE WASHER, KIT (SET OF 4) OD .635, ID .41, THK .08
9PI01	POLY INSERT 1", 14-20 GA BLK MATTE ,INSERT FINIS .94/.95
9PI02	POLY INSERT 3/4", 14-20 GA BLK MATTE FINISH, INSERT FINIS 0.69
9SV-WL1	WINDSHIELD LATCH KIT 1, POPS OPEN W/S FOR VENTING ONLY
9SV-VM01	5/8" THICK RUBBER BUMPER (2)
9SV-HWK-00083	HARDWARE KIT JOHN DEERE 3E
9SV-9HR04	THICK PANEL SNAP BUSHINGS, .937ID X 1.093OD, SET OF 2
9SV-9HR-00005	TEE FITTING, 1-1/8" X 1-1/8" X 5/8"
9SV-9HR0045	BLOCK ADAPTER (3/8" NIPPLE)
9SV-9HR00601.0	HOSE CLAMPS #10 (1"), SET OF 6
9SV-9HR00601.5	HOSE CLAMPS #16 (1.5"), SET OF 2
9SV-UHTRILV	UNIVERSAL HEATER IN-LINE VALVE (SET OF 2)
9SV-9HR0048	ROCKER SWITCH (HI-OFF-LOW)
9SV-9HR-L	REPLACEMENT LOUVER-15,000 & 20,000 BTU HEATER, KL47
8SV-9PH20WG	TUCK-AWAY HEATER WITH WIRED GROUND
9SV-HRH61-20	HEATER HOSE (5/8" I.D.)-20 FT
9PH20-2	FAN 120 x 120 x 38 12VDC 12W 3200 RPM
9SV-WH-00072	WIRING HARNESS POWER
8SV-WH-GF	WIRE HARNESS, GLASS FUSE
9DL01H	KEYS, SET OF 2 ON A RING, FOR HANDLE 1096-1, KEY CODE C40

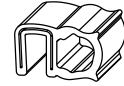
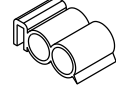
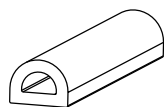
5/8" STD BULB, 1/16" GRIP	1" FLAT BULB, 1/16" GRIP	WINDOW RUBBER	FOAM TAPE, 1/8" X 2"	3/4" SIDE BULB, 1/4" GRIP	1-1/2" D. SIDE BULB, 1/16" GRIP	ARCH PSA RUBBER .2 X .15
						
9SV-PRO2-15	9SV-PRO5-10	9SV-PR10-20	9SV-PR35-5	9SV-PR38-15	9SV-PR41-5	9SV-PR53-15

OPTIONAL ACCESSORIES FOR JOHN DEERE 3E CABS

FRONT LED WORK LIGHTS (P/N: 9LEDW4)

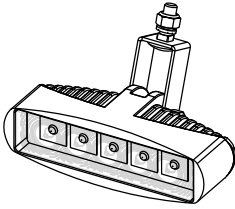

REAR LED WORK LIGHTS (P/N: 9LEDW3)

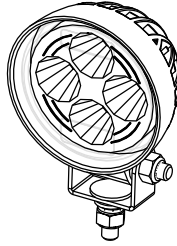

STROBE LIGHT (P/N: 9LEDS2)

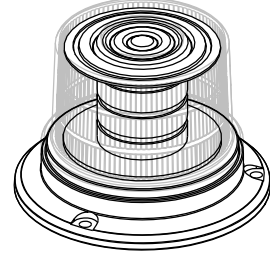

DOME LIGHT (P/N: 9LEDD14)

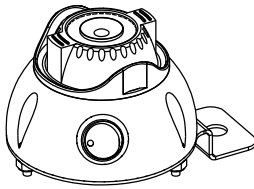

SIDE VIEW MIRRORS (P/N: 9PM5)

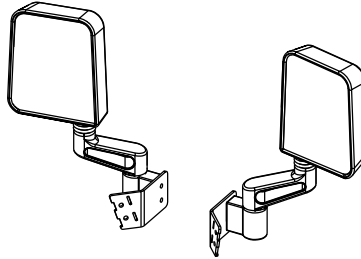

REAR VIEW MIRROR (P/N: 9PM3)

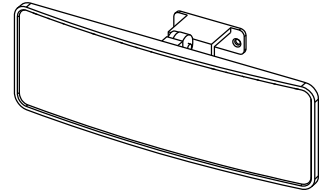

REAR WIPER KIT, 85 DEG W/ 12" FLEX BLADE (P/N: 9PWK8512F9-11A)

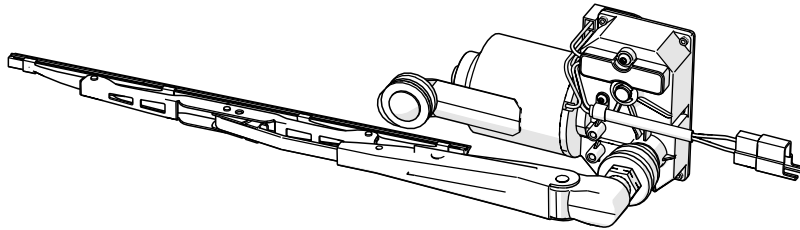

SEAL KIT (P/N: 9SK2)

